

COURSES AND DISTANCES

UP MILL CREEK

N 15 W	19
N 20 W	8
N 51 W	23
North	6
N 54 W	<u>19.5</u>
	75.5

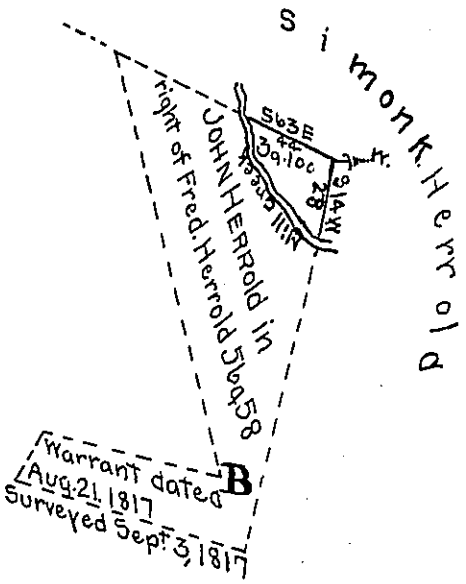

(No description given)

IN TESTIMONY that the above is a copy of the original remaining on file in the Department of Internal Affairs of Pennsylvania, made conformably to an Act of Assembly approved the 16th day of February, 1833, I have hereunto set my Hand and caused the Seal of said Department to be affixed at Harrisburg, this twentieth day of March 1905

George P. Brown
 Secretary of Internal Affairs.